

# Best Project of South Delhi

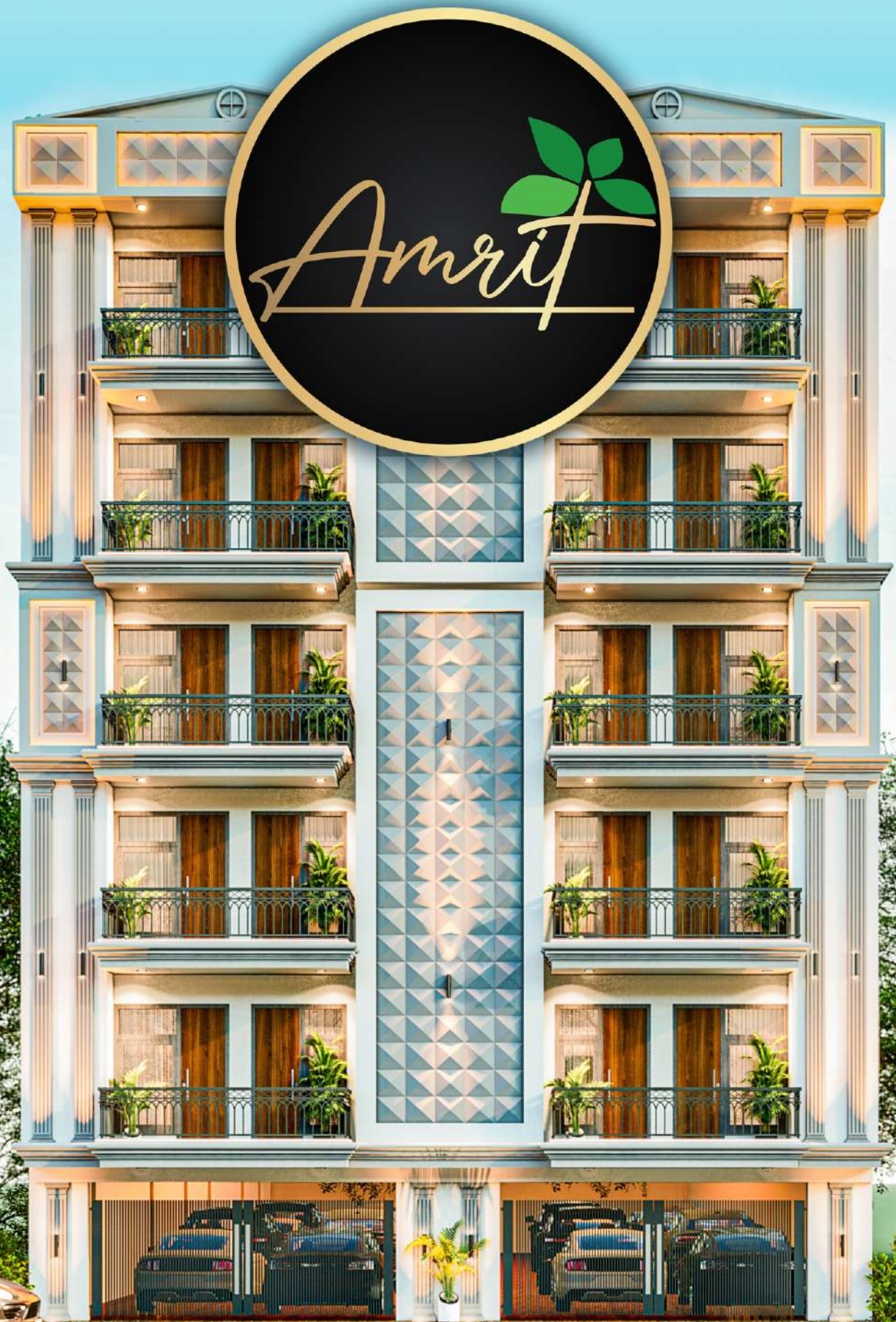

FARM FACING  
**3BHK**  
REGISTRY PROJECT





**BUILDING FACING NORTH**

**TOTAL AREA  
550 SQ.YD.**

**3 BHK FLAT  
IN  
135 SQ.YD.**

**25 FEET FRONT ROAD**



# TERRACE GARDEN VIEW

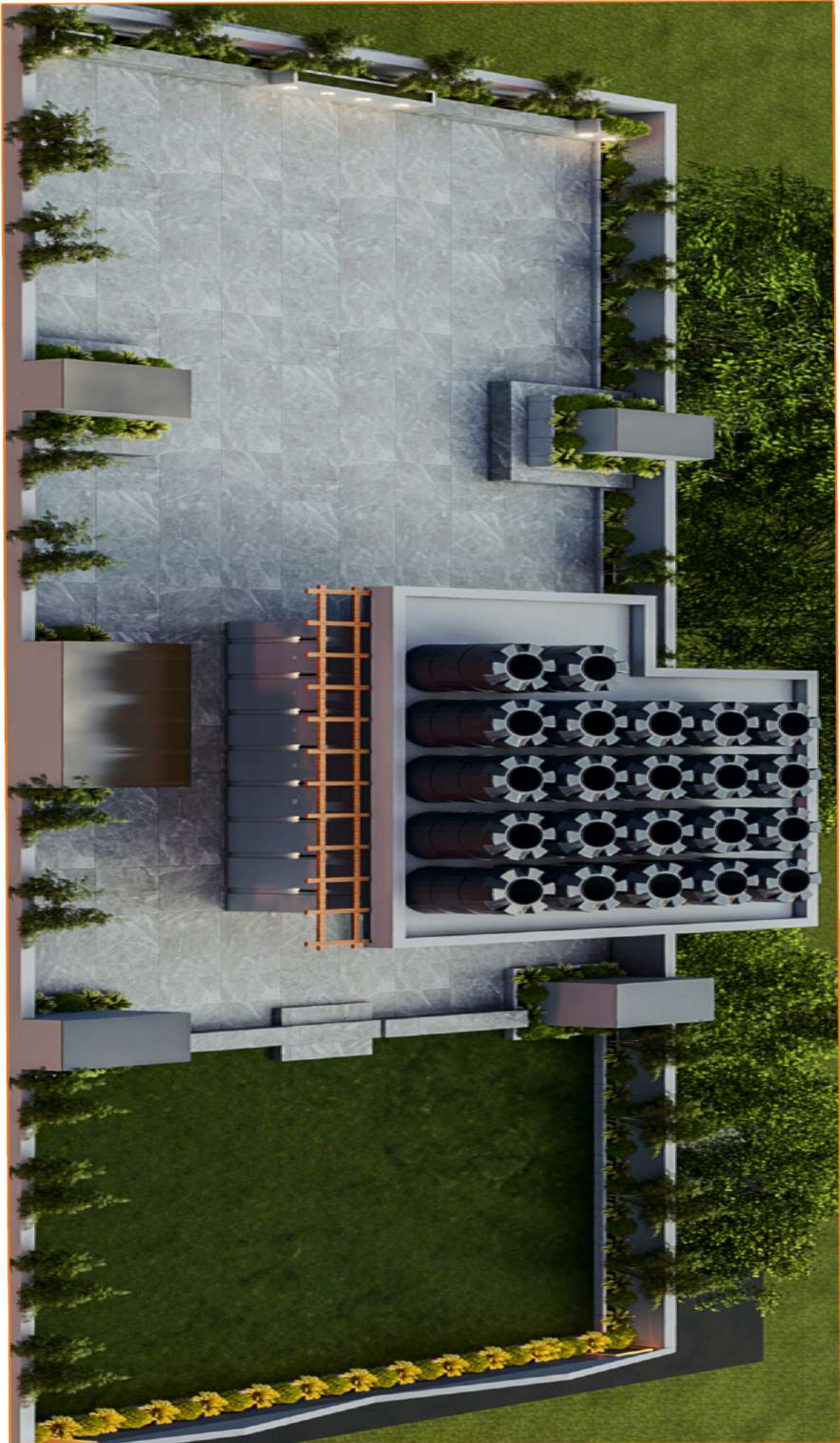

# PARKING

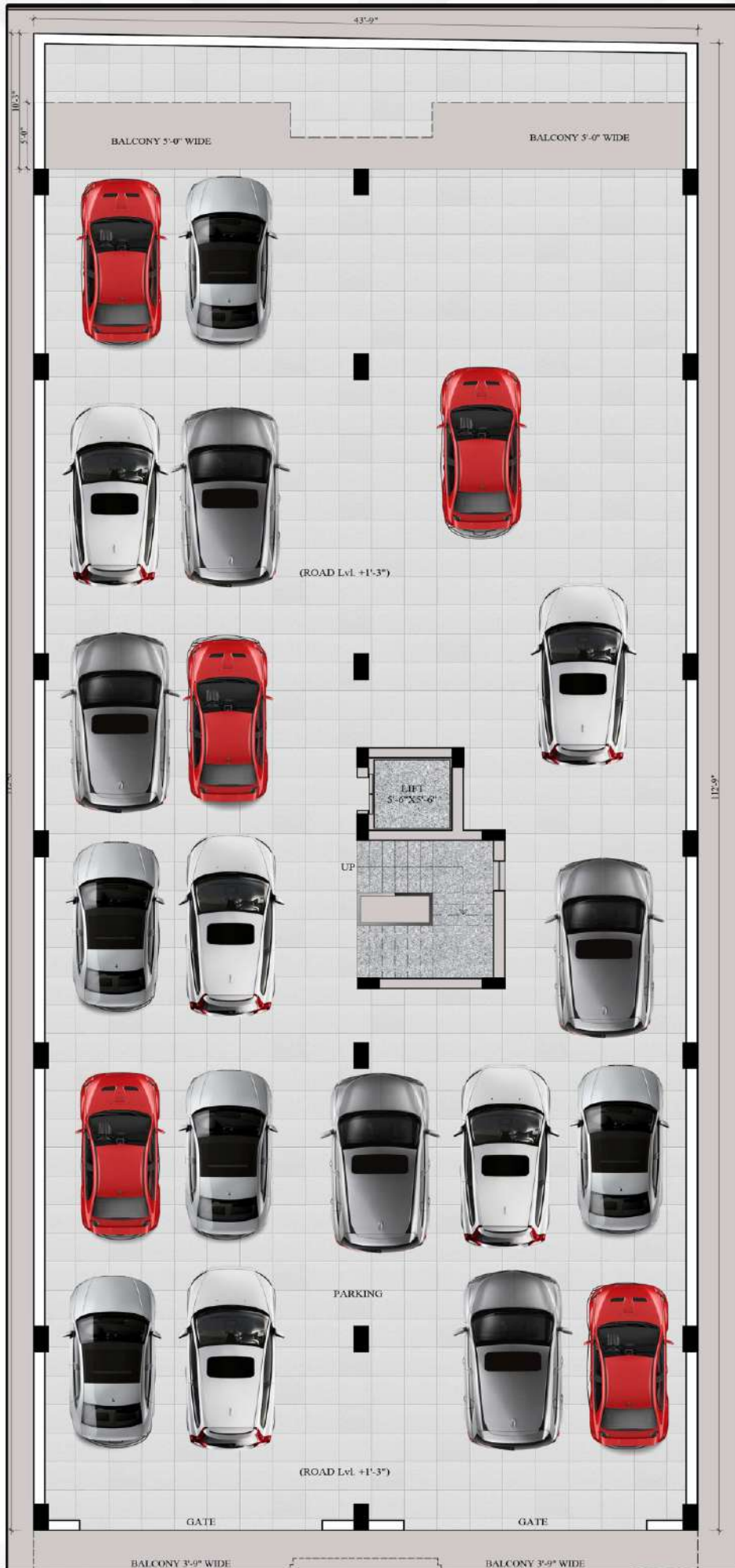



# FEATURES & AMENITIES



**BRANDED LIFT**

**MODULAR KITCHEN**

**FANS**

**DIGITAL LOCK**

**GEYSER**

**FITTINGS**

**TERRACE GARDEN**

**CHIMNEY**

**Yale**

**Dorsët**

**CERA**

**hindware**

**Jaquar**

**Crompton**

**HAVELLS**

**Crompton**

**elica**

- PARKING GRANITE FLOORING 
- ELECTRICALS POLYCAB / HAVELLS
- GUARD ROOM 

# CONNECTIVITY

RAJPUR EXTENSION, South Delhi



- \* Approx 2.5 Km. from Qutub Metro Station & Chattarpur Metro Station.
- \* Approx 1.5 km from silver line upcoming Metro station chattarpur.
- \* 500 mtr. Bus stop
- \* Airport is just 12 km.
- \* Gurugram border 9 km.





**Contact Us For Booking**  
**9871057424**  
**7428577424**  
**[www.sastaghar.in](http://www.sastaghar.in)**

